



Wildlife Guard for Bushings with/without Handwheel

Installation Manual



ATTENTION!

Read and understand the information contained in this instruction manual before installing, operating, and/or maintaining your Prolec Celeco® wildlife guard.

The product covered by this manual must be installed, operated, and maintained exclusively by specialized and qualified personnel.

Introduction

Prolec Celeco® wildlife guard for bushings with handwheel is manufactured with flame retardant material, prevent outages caused by wildlife contact to exposed high voltage bushings and surge arresters on overhead distribution transformers.

Contact Information

For more information about our product and sales network, please visit our website at www.prolec.energy or email us at info@prolec.energy. We are also available by phone at +52 (81) 8030-2000 or 800-437-7653.

INDEX

Introduction.....	3
Contact Information	3
1. Initial Inspection	5
3. Technical Specifications.....	5
4. General Dimensions	5
5. Installation.....	6

1. Initial Inspection

Upon receipt of Prolec Celeco® wildlife guard for bushings with handwheel, carefully inspect the shipping container for any bumps or any signs of damage. When unpacking the guard, inspect it thoroughly to verify the integrity of the equipment and rule out any damage that may have occurred during shipping.

2. Handling and Storage

Keep the equipment in a clean and dry environment if it is necessary to safeguard the equipment prior to installation.

3. Technical Specifications

Prolec Celeco® wildlife guard for bushings with handwheel complies with the IEEE 1656-2010™ standard testing.

Self-extinguishing guards:

- Prevent Wildlife Damage
- Robust and rigid material
- Enhanced polypropylene resin for long life
- Achieves a V0 flammability rating, the highest rating for the UL94 test standard.

4. General Dimensions

Dimensions are shown in the next figure.

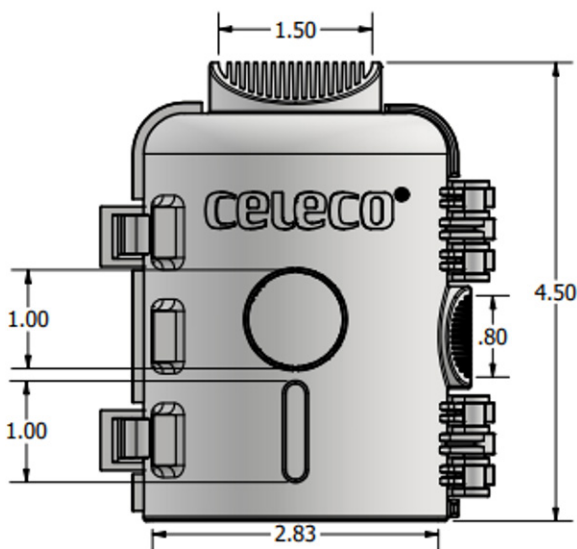

Fig. 1. General Dimensions. Units expressed in inches

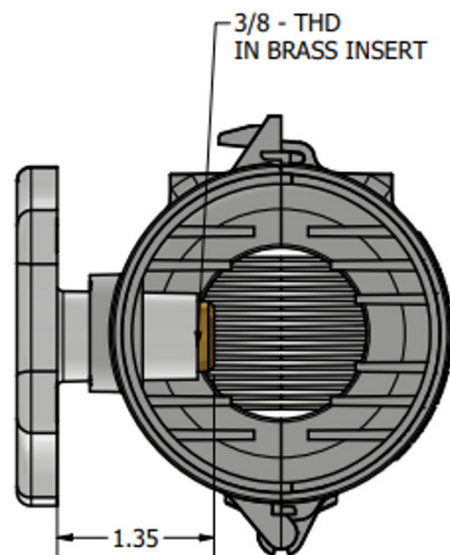

Fig. 2. Handwheel General Dimensions. Units expressed in inches.

5. Installation

Prolec Celeco® wildlife guard for bushings with handwheel installation is easy due to their innovative snap-fit locking system.

Follow the next steps to achieve a secure installation of the bushing guard:

1. Identify the Snap-fits in the guard.

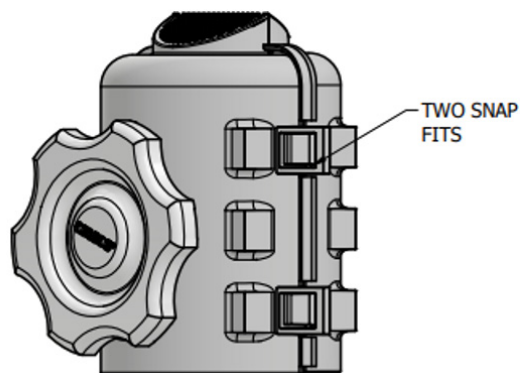

Fig. 3. Snap fit system.

2. Place the guard around the bushing connector, verify the incoming cabling and verify that the components are correctly aligned. Close the guard and follow the next steps.

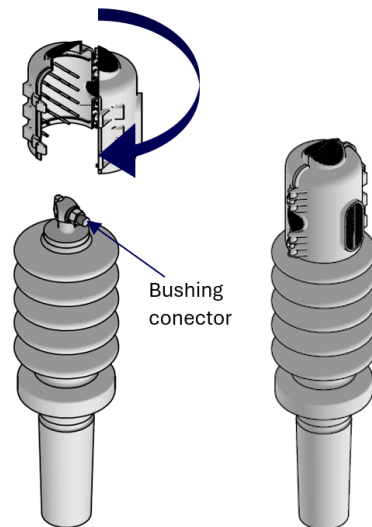

Fig. 4. Connector Bushing Mounting

3. Press the lateral snaps one after another to secure the lateral side. Make sure the insertion of the snaps into the holders is aligned according to the next figures and make sure that it is correctly secured.

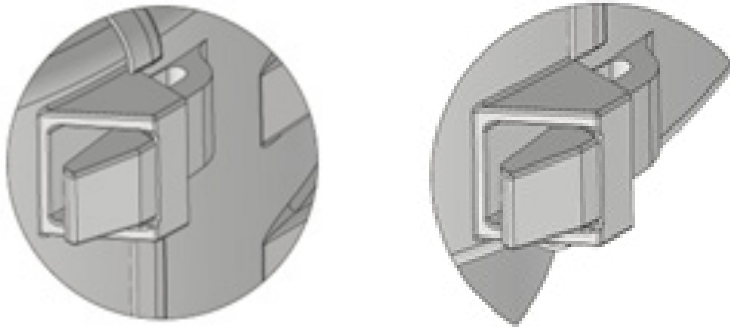

Fig. 5. Snap fit gripping.

4. In case of using the handwheel accessory, make sure the grid slot of the guard is installed facing front of the bushing connector. Introduce and screw the handwheel to the connector as it is shown in the next figures.

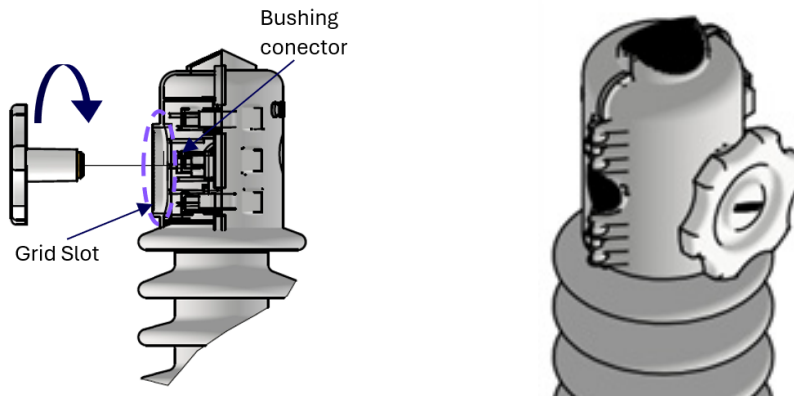

Fig. 6. Bushing connector screw facing front of grid slot. Screwing of the wheel to the bushing connector.

5. To remove the guard assembly, first remove the handwheel and then release the lateral snaps from the holders.



LOCATIONS

MEXICO

APODACA

Blvd. Carlos Salinas de Gortari km. 9.25
Apodaca, NL 66600 MX
+52 (81) 8030-2000

USA

SHREVEPORT

7000 W Bert Kouns Industrial Loop
Shreveport, LA 71129
+1 (318) 687-6600

WAUKESHA

400 S Prairie Ave.
Waukesha, WI 53186
+1 (262) 547-0121

GOLDSBORO

2701 US Highway 117 South
Goldsboro, NC 27530
+1 (919) 734-8900

DALLAS

9011 Governors Row
Dallas, TX 75247
+1 (214) 637-4434

BRAZIL

CANOAS

Avenida Guilherme Schell, 11500
Canoas, RS 92.420-820
+55 [51] 3477-8686

For more information:
info@prolec.energy

prolec.energy

